

Cleaning & Care

- ◆ Unplug the appliance before cleaning.
- ◆ Do not use any water or chemical-based solutions for cleaning metal surfaces.
- ◆ Slightly moisten a cloth and then wipe off the surfaces of the fan.
- ◆ In order to remove the dust from the protective fan grille use a vacuum cleaner or reverse the assembly instructions ~ undo safety screw, open securing clips on grille edge and wipe fan blades with a damp cloth.
- ◆ Ensure fan is completely dry and the fan grille securely refitted before storage or reconnecting to electrical supply.
- ◆ Never immerse the fan or fan motor in water or other liquid.
- ◆ If the fan is not used for long periods, protect with a suitable cover after cleaning, then store in a dry place.

This appliance complies with both the low voltage and electromagnetic compatibility directives. Its construction complies with current safety standards. We reserve the right to make technical changes without prior notice.

Disposal

The packaging of your new fan has a recycle mark on it. Please dispose of it as recycled paper or by using the "Dual System".



The symbol  on the product or on its packaging indicates that this product may not be treated as general household waste. Instead it should be handed over to the applicable collection point for the recycling of electrical and electronic equipment. By ensuring this product is disposed of correctly, you will help prevent potential negative consequences for the environment and human health, which could otherwise be caused by inappropriate waste handling of this product. For more detailed information about the recycling of this product, please contact your local council office, your household waste disposal service, the store where you purchased the product or visit www.recycle-more.co.uk.

UK guarantee

For 12 months warranty in respect of defects found to be due to faulty workmanship or material. Proof of purchase is required for validity of the guarantee. This guarantee is no longer valid if the damage has been caused by fall, alteration or repair by any unauthorised persons. This guarantee in no way affects your statutory rights.

Technical Data

Model No: SF-1616-MPC
Power: 60W
Voltage: 220-240V ~ 50Hz
Ref: IM/SF1616/1505/GU86AA
Product Dims: 450 x 410 x 1250 mm (L*W*H)
adjustable height 900 to 1250mm
NW: 5.6kg
GW: 6.4kg
Class II Product



© 2019 Newton Stovold Assocs Ltd
GU8 6AA / www.nsauk.com

NSA^{UK}
newton stovold associates

Antique
Pedestal Fan
16" / 40 cm
Model SF-1616-MPC



Instruction manual

- ❖ 3 speeds
- ❖ 4 metal blades
- ❖ Rotary controls
- ❖ Oscillation
- ❖ Tilt
- ❖ Carry handle
- ❖ Height adjustable to 1.25m
- ❖ Round base

Please keep safe for future reference

Pedestal Fan

Thank you for purchasing this adjustable height pedestal fan. Please read the instructions and warnings carefully before use to ensure safe and satisfactory operation of this product. Please retain this information for future reference.

CAUTION:

Use the fan only as described in this manual. Misuse may cause a fire or an electric shock

- Do not operate the fan with a damaged power cord or plug, after it malfunctions, has been dropped or damaged in any way. If the power cord is damaged it must be replaced by a qualified service engineer to avoid a hazard.
- Close supervision is necessary when this fan is used near children and pets.
- Always turn off the fan after use, before cleaning or moving location.
- Do not insert fingers or other objects into the fan guard.
- Do not operate the fan in areas where petrol, paint or other flammable liquids are used or stored.
- Do not place the fan near an open flame, cooking or heating appliance or hot surface.
- This fan is not intended for use in wet or damp locations. Never position the fan in an area where it may fall into a bath or other water container.
- This fan should not be operated outside.
- Always use on a dry, level surface.
- Do not let the power cord hang over the edge of a table or counter.
- Arrange the power cord away from an area where it may be tripped over.
- Never place the power cord under a carpet or rug.
- To disconnect from the power supply, grip the plug and pull from the power socket. Never pull by the cord.
- Do not hang or mount the fan on a wall or ceiling.
- This product is designed for household and light commercial use ONLY.
- This appliance can be used by children aged from 8 yrs and above and persons with reduced physical, sensory or mental capabilities or lack of experience and knowledge if they have been given supervision or instruction concerning use of the appliance in a safe way and understand the hazards involved.

Assembly

- Loosen the pillar nut (16) from main pillar (14), insert the main pillar (14) into the hole of the fan base (15) and secure with the base pillar nut & washer (16).
- Unscrew fixing screw B (13) and adjust height to suit. Re-tighten fixing screw B (13) once desired height is achieved.
- Insert the motor housing (8) into the upper main pillar (14) and then fasten with fixing screw A (12).
- Remove fan blade nut (3) and the rear grille securing nut (5) from the motor cover and secure the rear grille (6) to the motor cover using the three pins to align it; fasten with rear grille securing nut (5).
- Push the fan blade (4) onto the motor shaft (7) until the fan blade is fully seated. For models with shaft pins, push the fan blade (4) onto the motor shaft by matching the slots on the rear of the blade with the shaft pin.

Appliance components

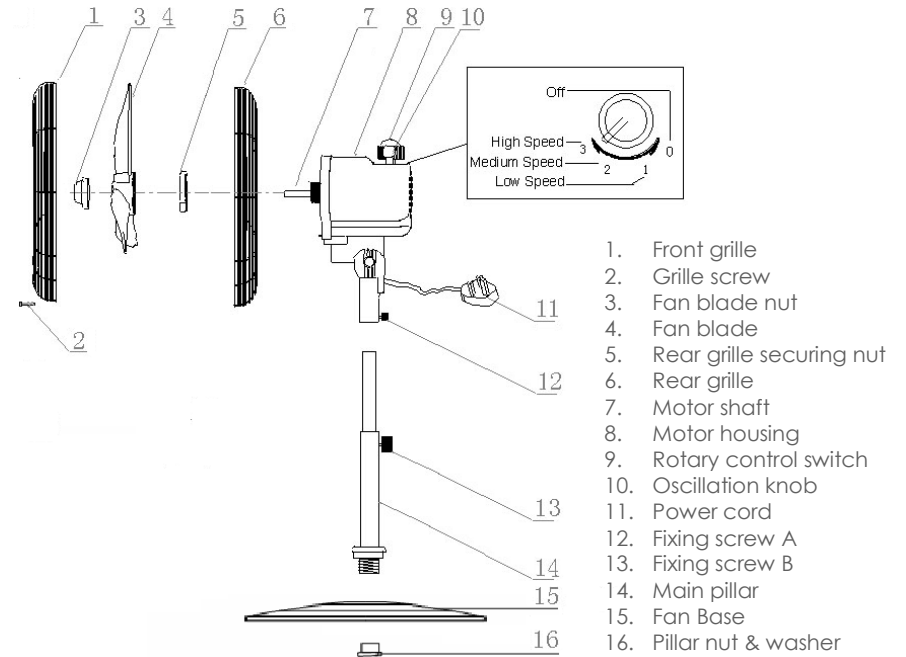

Assembly (cont'd)

- Secure the fan blade (4) with the fan blade nut (3). The blade nut (3) must be tightened by turning it counter clockwise. Check that the fan blade (4) rotates freely by turning it with your hand. If it does not – check the rear grille (6) is correctly aligned on the motor housing, the rear grille nut (5) is fitted correctly and the locking cap (3) is correctly threaded & securely tightened.
- Open the securing clips around the rear grille (1) and loosen the grille screw and nut (2) at the bottom of the front grille (1). Position the front grille (1) hook on the uppermost part of the rear grille (6). Push the hook down and press rim of the front grille (1) onto the rear grille (6). Close all clips around the edge and tighten the grille screw securely (2).

Operation

- Position your fan on a dry, level surface & plug into an electrical socket.
- To switch on the fan, turn the rotary speed control switch (9) to position 1, 2, or 3 as desired. 0 = Off.
- To assist the flow of air around the room push down the oscillation knob (10) located on the top of the motor housing (8).
- To stop the fan from oscillating, pull up on the oscillation knob (10).
- Airflow can be adjusted upwards or downwards by simply tilting the fan head to the desired level. DO NOT tilt fan head when the fan is on; this may damage the mechanism.